ULTRA SMALL STUB ANTENNA

- **Very small Antenna**
- **868 MHz**
- **GSM 900/1800 MHz**
- **2.4 GHz**
- **SMA connector**

ADA-008X-I is an ultra small ground plane dependent stub antenna with a straight SMA connector.

It is designed to work perfect with all products that already have an internal ground plane.

The small PVC covered Stub antenna is easy to place and use even in narrow areas.

ADA-008X-I is available for different frequencies.



ADA-008X-I

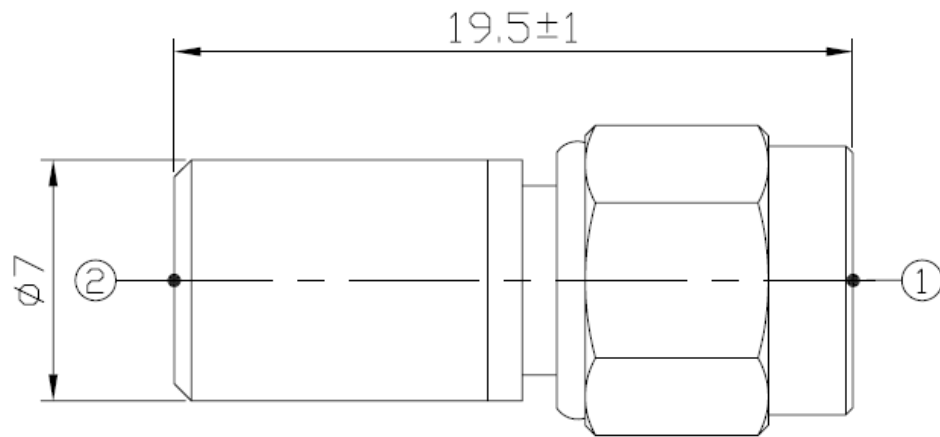

NO.	NAME	MATERIAL	FINISH	Q'TY
1	SMA 180° (Male)	Brass	Nickel Plating	1
2	Ant, shell	ABS	Black	1

ADA-008X-I-868 RL

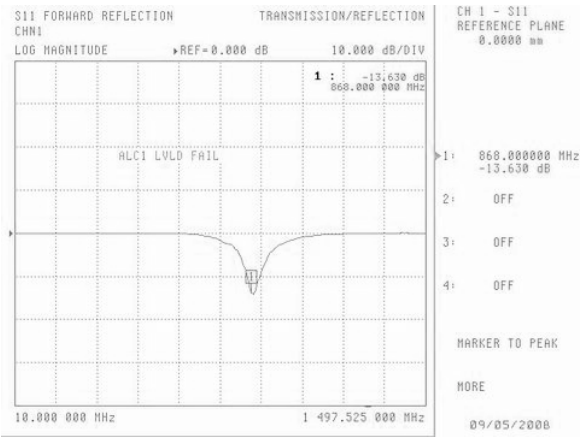

ADA-008X-I-868 SC

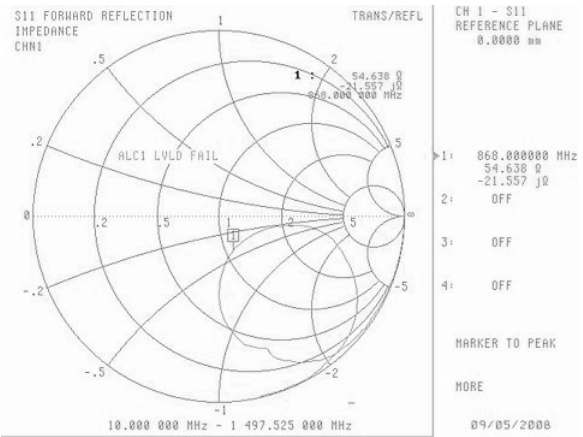

ADA-008X-I-868 VSWR

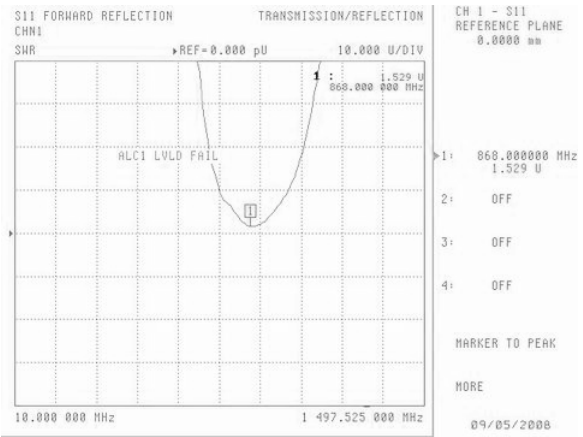

ADA-008X-I-2.4 RL

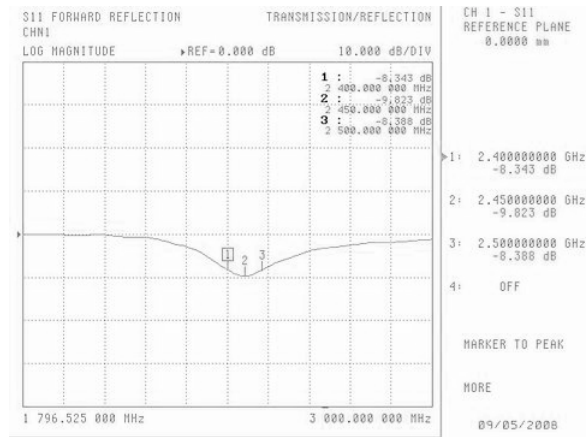

ADA-008X-I-2.4 SC

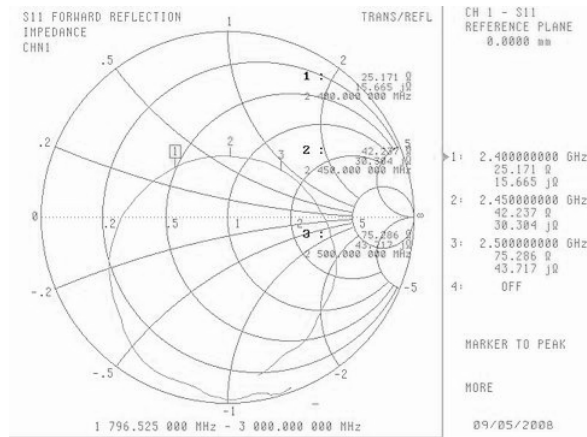

ADA-008X-I-2.4 VSWR

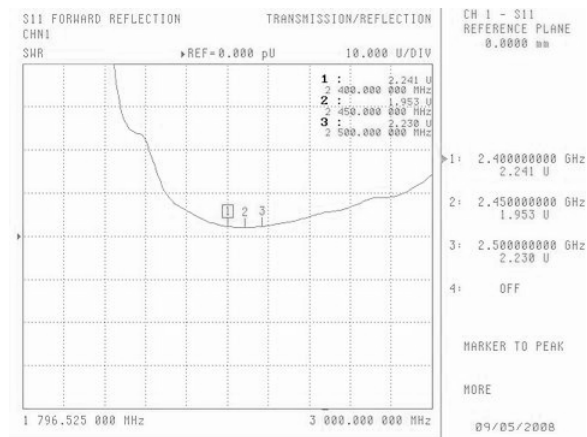

ADA-008X-I-900/1800 RL

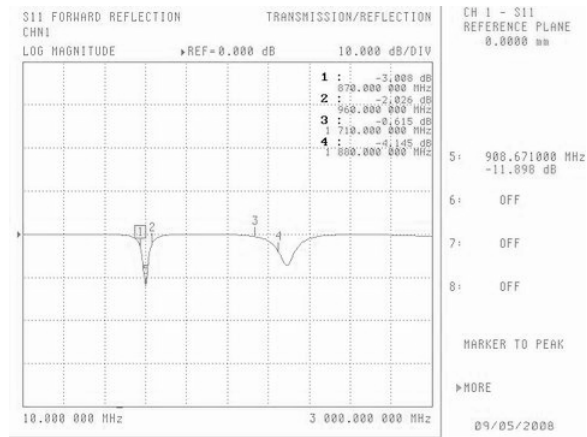

ADA-008X-I-900/1800 SC

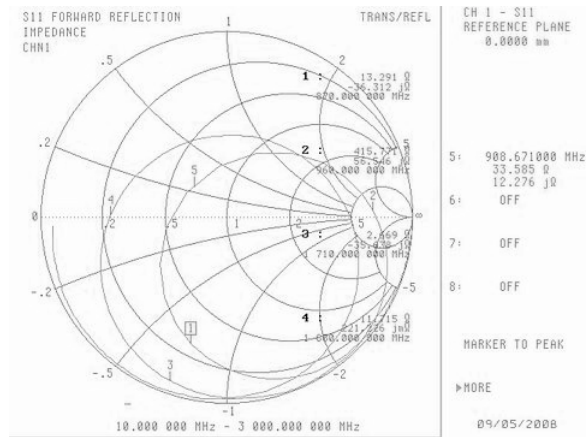

ADA-008X-I-900/1800 VSWR

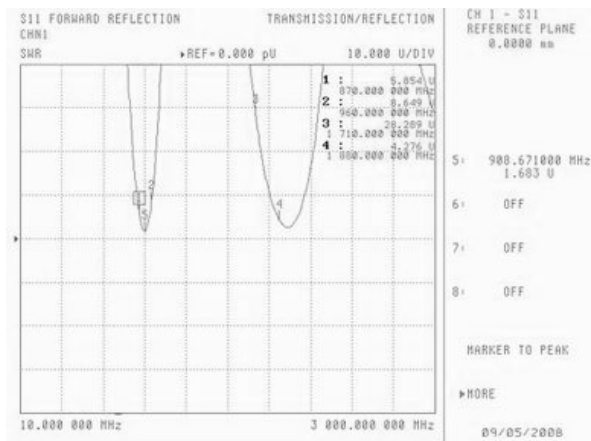

Ordering codes

TYPE	Description	Comment
ADA-008X-I-868	SMA connector	868 MHz antenna
ADA-008X-I-2.4	SMA connector	2.4 GHz antenna
ADA-008X-I-900/1800	SMA connector	GSM dual band antenna

For the latest updates, visit our Web site: www.adactus.se

Disclaimer

Information furnished is believed to be accurate and reliable. However, Adactus assumes no responsibility for the consequences of use of such information nor for any infringement of patents or other rights of third parties which may result from its use.

Adactus reserves the right to make changes without further notice to any product herein to improve reliability, function or design. Adactus does not assume any liability arising out of the application or use of any product described herein.

This publication supersedes and replaces all information previously supplied.

Adactus products are not authorized as critical components in life support devices or systems.