

WLAN HIGH GAIN ANTENNA

- **WLAN**
- **2.4 GHz**
- **8/12 dB Gain**
- **Wall mounted**

ADA-0057 is a high gain WLAN wall mount antenna. It's available in two different versions, either 8 or 12 dB gain.

ADA-0057 is suitable for image/data/voice communications and wireless LAN systems.



Specification

	Overall performance	
Category	ADA-0057-8	ADA-0057-12
Frequency	2400 – 2485 MHz	2400 – 2485 MHz
Max gain	8 dB	12 dB
Impedance	50 Ω	50 Ω
SWR	≤ 1.3	≤ 1.3
Max input power	50W	50W
Type	Panel	Panel
Radiation	Directional	Directional
Polarization	Vertical	Vertical
Beamwidth deg.	Horz. 75° Vert. 75°	Horz. 75° Vert. 75°
Connector	N female	N female
Dimension	107 x 94 x 30 mm (L,W,H)	214 x 94 x 30 mm (L,W,H)
Weight	0.3 kg	0.5 kg
Radiator	Copper	Copper
Radome	ABS	ABS

Return Loss

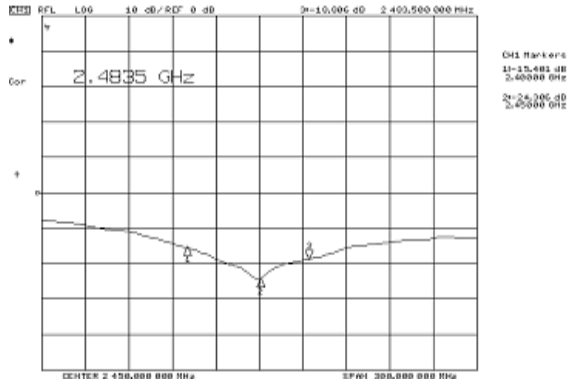

E-PLANE FIELD PATTERNS

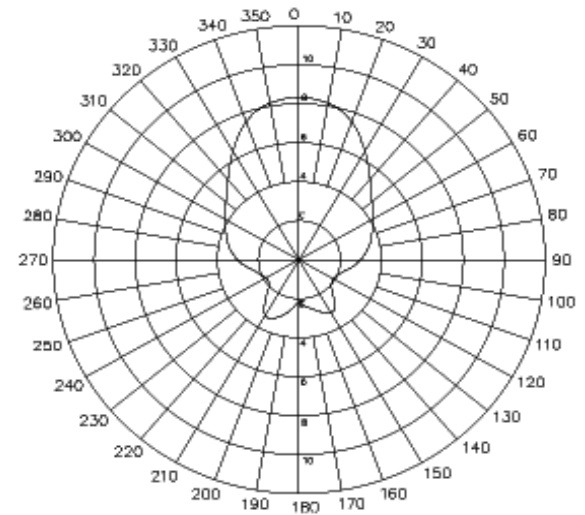

VSWR

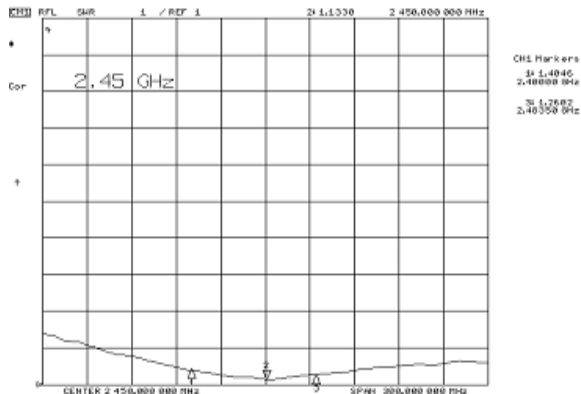

H-PLANE FIELD PATTERNS

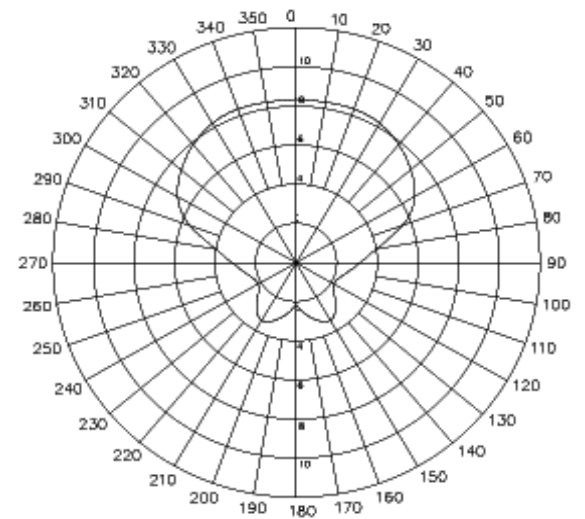

Return Loss

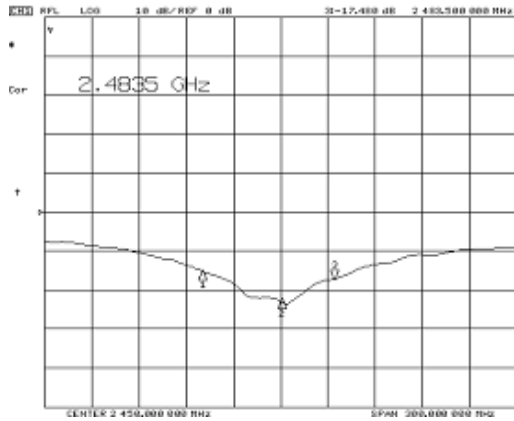

E-PLANE FIELD PATTERNS

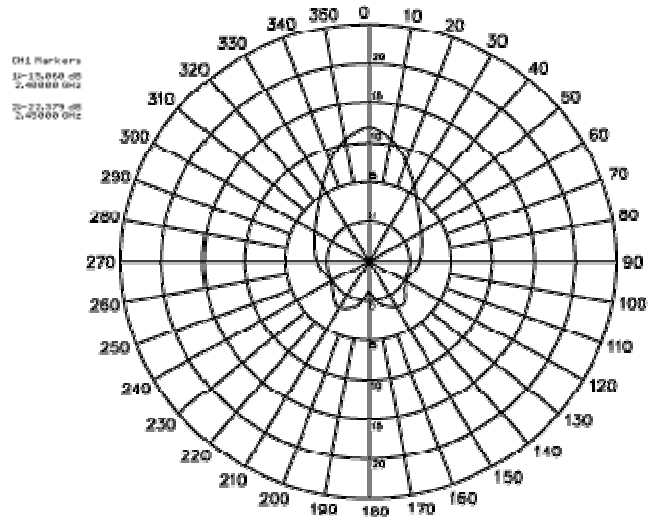

VSWR

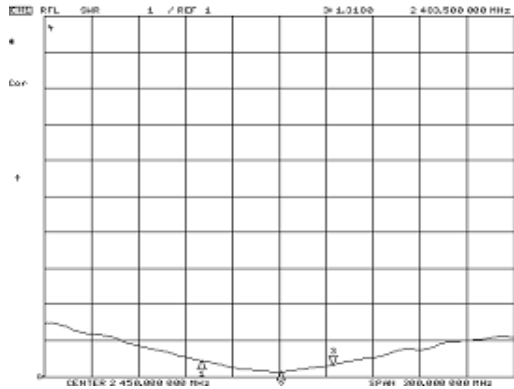

H-PLANE FIELD PATTERNS

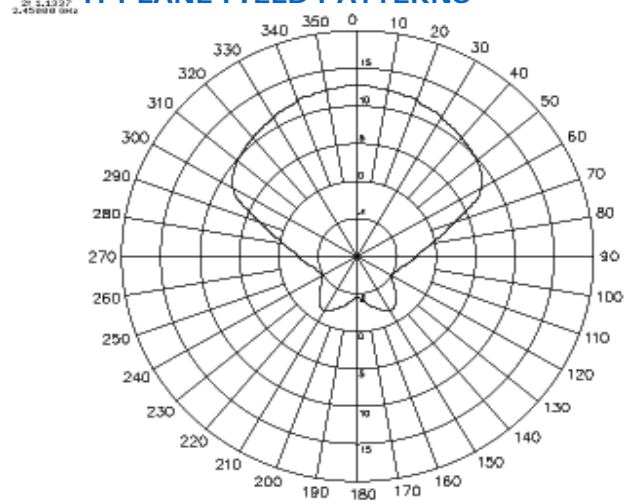

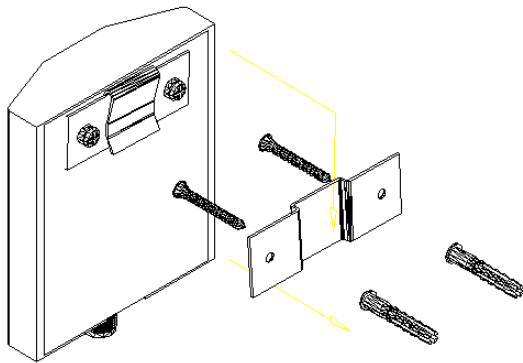

ADA-0057-8

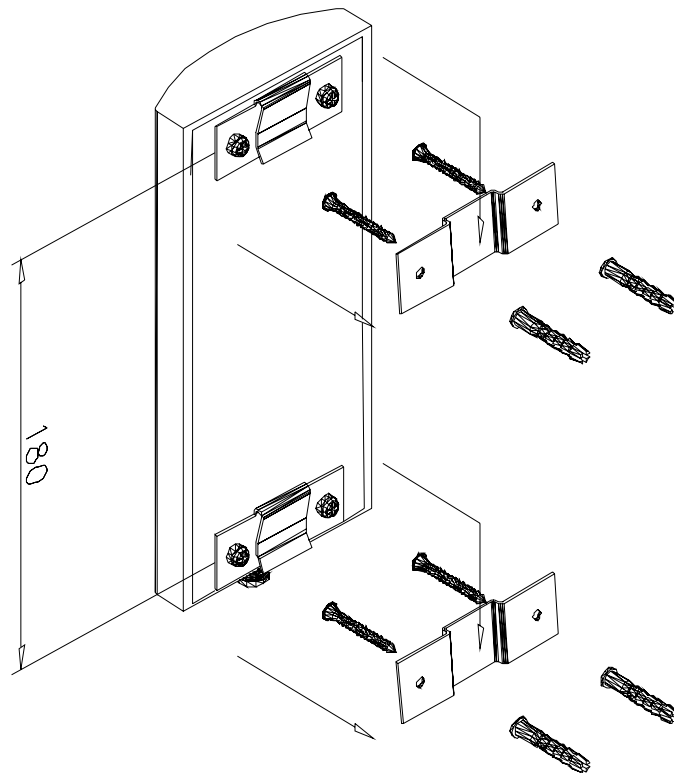

ADA-0057-12

Ordering codes

TYPE	Description	Comment
ADA-0057-8	8 dB Gain antenna	WLAN antenna
ADA-0057-12	12 dB Gain antenna	WLAN antenna

For the latest updates, visit our Web site: www.adactus.se

Disclaimer

Information furnished is believed to be accurate and reliable. However, Adactus assumes no responsibility for the consequences of use of such information nor for any infringement of patents or other rights of third parties which may result from its use. Adactus reserves the right to make changes without further notice to any product herein to improve reliability, function or design. Adactus does not assume any liability arising out of the application or use of any product described herein. This publication supersedes and replaces all information previously supplied. Adactus products are not authorized as critical components in life support devices or systems.